

reception+operation+Maintenance

**MLDU Flex**  
Access2

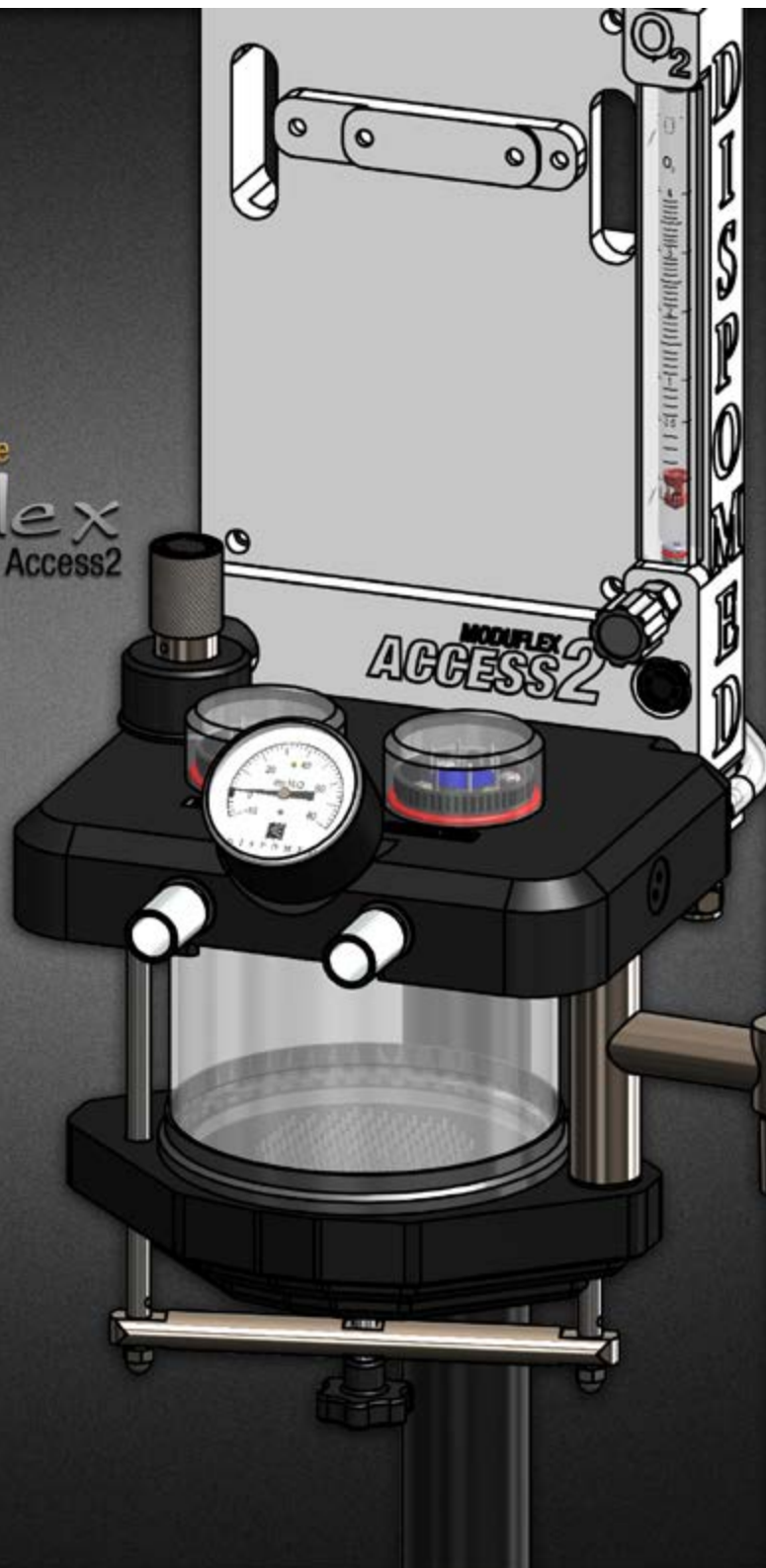

# TABLE OF CONTENTS



---

User Responsibility . . . . .	3
Standard and optional features . . . . .	4
Receiving and Assembly Instructions . . . . .	5 - 10
Optional accessories Assembly Instructions . .	12
Daily Leak Check Procedure . . . . .	17-18
Annual Maintenance . . . . .	19
Consumables Materials List . . . . .	20
Warranty . . . . .	21
Order Part Numbers . . . . .	22 - 23

**Read this manual before operating the unit. Pay special attention to all warnings and cautions.**

- This product will perform in conformity with the description contained in this operating manual when assembled, operated, maintained and repaired in accordance with the instructions provided.
- This product must be verified periodically.
- A defective product should not be used.
- Parts that are broken, missing, plainly worn, distorted or contaminated should be replaced immediately.
- Should a repair or replacement become necessary, Dispomed recommends that a request be placed by phone or in writing to the nearest Dispomed regional service center.
- This product, or any of its parts, should not be repaired other than in accordance with written instructions provided by Dispomed and by Dispomed trained personnel.
- The product may not be altered without prior written approval from Dispomed.
- The user of this product shall have the sole responsibility for any malfunction which results from improper use, faulty maintenance, improper repair, damage or alteration by anyone other than a Dispomed trained technician.



## STANDARD FEATURES

- 0.1 to 4 LPM O<sub>2</sub> flowmeter
- Rotary float and large scale for easy readability
- Recessed flush valve to prevent accidental activation
- Both the anesthesia machine head and the absorber head are precision machined to reduce the amount of connections which greatly reduces the risk of leaks
- Quick connect fresh gas outlet for easy and secure switching between breathing circuits
- Cage-mount compatible manifold for easy and quick installation of vaporizer
- Five caster spider base
- 1500 ml CO<sub>2</sub> absorber designed for easy and fast replenishing of sodalime
- Condensation trap to prevent water build-up in sodalime. Easy and efficient gas sealing
- Patient circuit with 2 and 3 liter bags and fresh gas outlet
- 5 year warranty

## OPTIONAL FEATURES

- Dual cylinder holder
- Bain circuit adaptor
- Circuit pressure alarm
- Shelf assembly
- MRI Compatibility

# RECEIVING AND ASSEMBLY INSTRUCTIONS

**MODU**Flex

Your Moduflex Access2 anesthesia machine requires some assembly.

## RECEIVING

In order to reduce the possibility of damage to a minimum during shipping, certain components have been detached from the unit. These components are packed separately within the shipping crate.

## INSPECTION

On receipt of your unit, inspect the shipping container and the enclosed components for signs of damage. Check your Materials List to ensure that all the necessary components are included.



DISPOMED

# RECEIVING, ASSEMBLY

INSTRUCTIONS CONTINUED

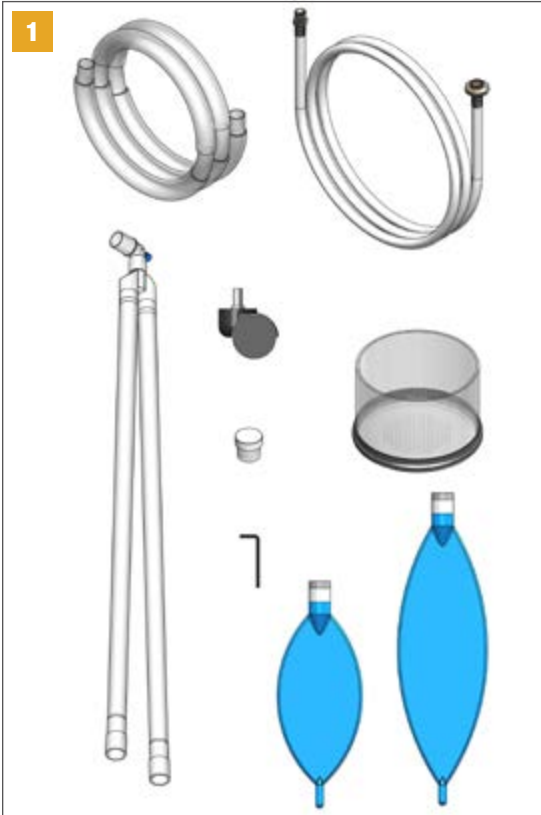

Remove the accessories found in the bag inside the large box.

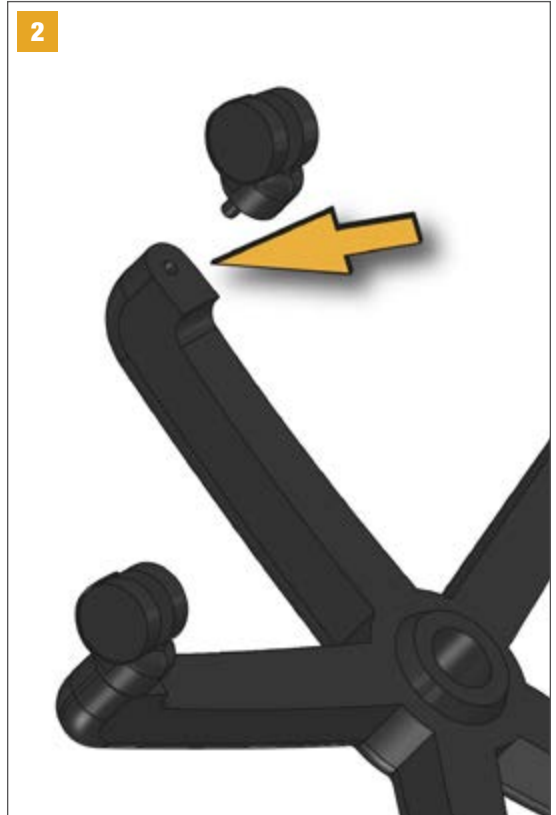

Remove the base from the box and install the casters.





Slide the tapered end of the black post into the base.



Remove the head assembly from the inner box and slide it onto the top of the black post.

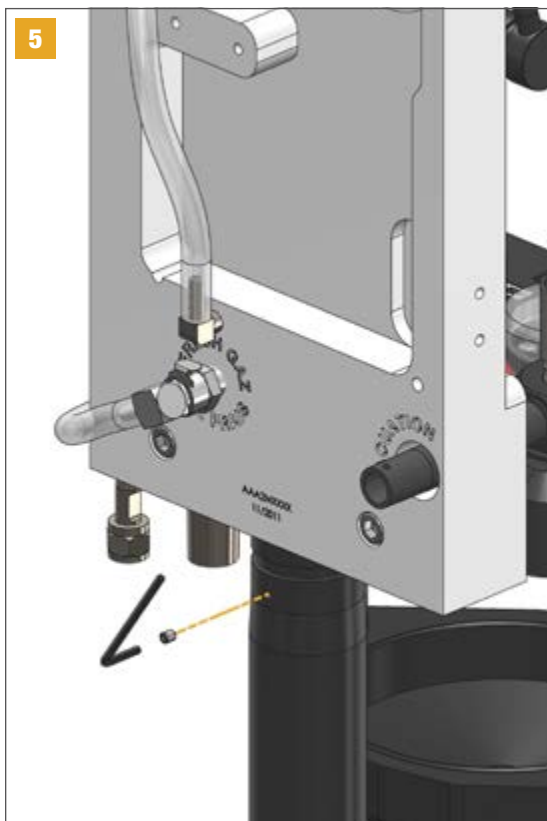

Tighten the head assembly on the back of the head using the Allen key supplied.



Install the vaporizer as indicated on page 12. Install a breathing bag on the rotary bag mount of the absorber.



# RECEIVING, ASSEMBLY

## INSTRUCTIONS CONTINUED

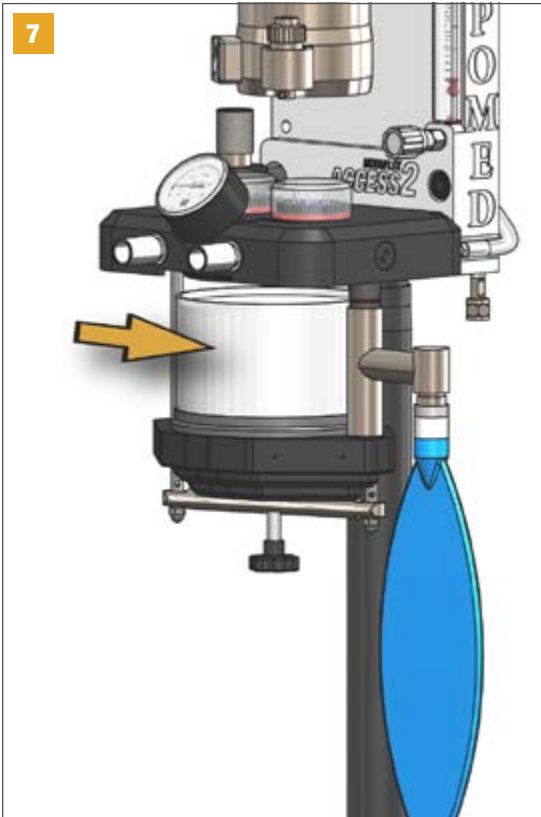

Fill the canister with absorbant using pre-packed or loose-fill granules (caution: do not overfill the canister; leave approximately 1/4" (5mm) from the top empty). Install the canister and tighten the sealing screw.

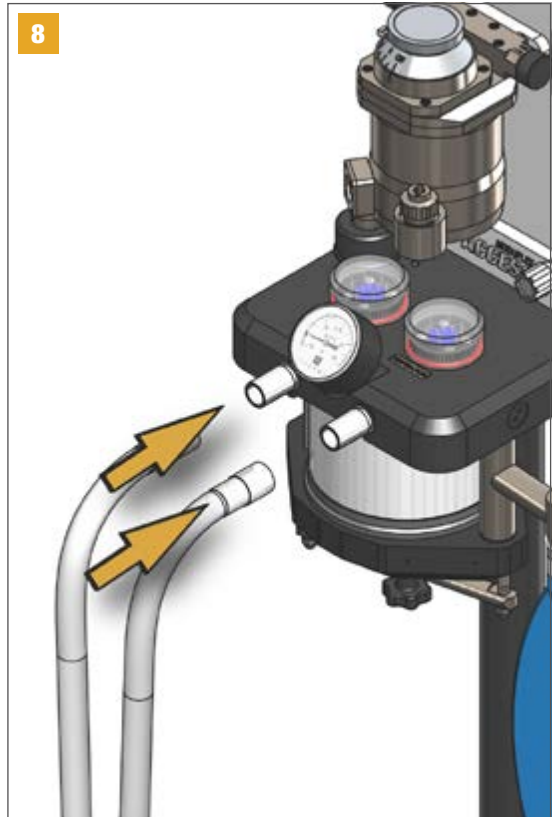

Install the patient circuit on the connections on the front of the absorber.



Install the oxygen supply hose to the back of the unit using 2 wrenches (5/8 and 11/16) in order to reduce the risk of accidentally disconnecting the hose.



Connect the other end of the oxygen supply hose to a 50 p.s.i. (3 bar) oxygen supply.

# ASSEMBLED VIEWS 1

**MODU**Flex



DISPO MED

# OPTIONAL ACCESSORIES

## ASSEMBLY INSTRUCTIONS

**MODU**Flex

### VAPORIZER REAR

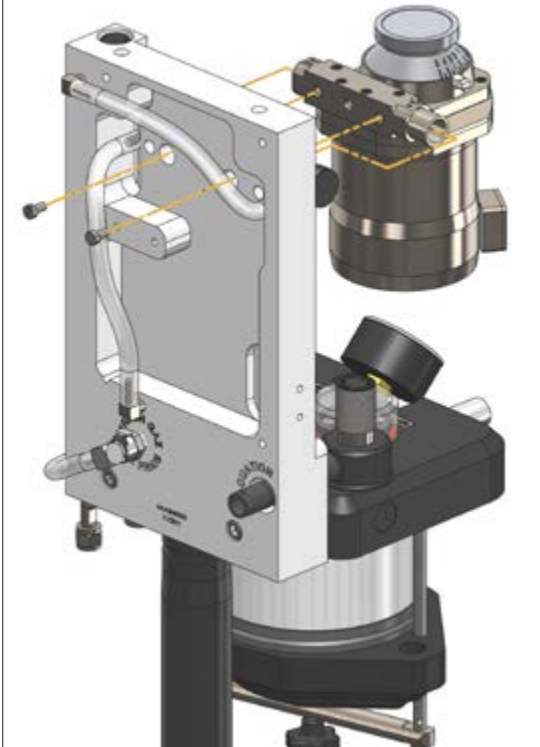

Mount the vaporizer on the unit using the appropriate vaporizer hardware and

### VAPORIZER FRONT

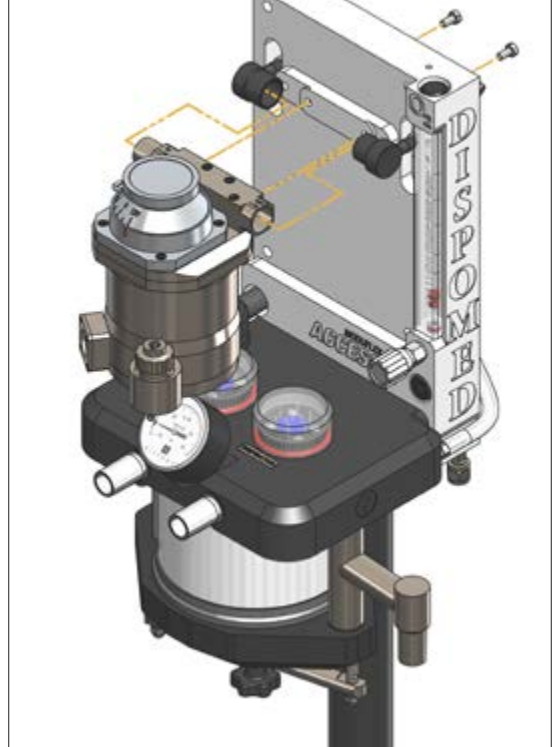

connect inlet-outlet fittings onto the vaporizer manifold.

**IMPORTANT** : Always refer to the user manual of the option you are installing for more detailed instructions.

# OPTIONAL ACCESSORIES

## ASSEMBLY INSTRUCTIONS

**MODU**Flex

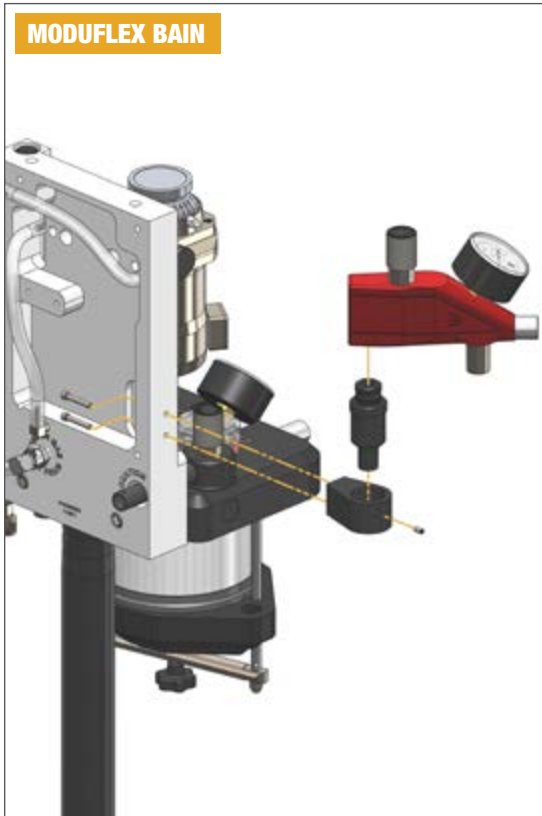

Install Bain circuit adaptor as illustrated.

A Bain type open circuit on an anesthesia machine gives you better control during surgery. The breathing bag is always inflated, no need to wait for it to have reached a certain size before ventilating the patient. The ModuFlex Bain is equipped with a pressure gauge that gives you the possibility to check the animal's lung pressure. The Bain adaptor is equipped with a momentary valve to avoid forgetting the valve in a closed position, which could cause pulmonary trauma to the animal.



Install the scavenger interface as per interface instructions.

During surgery the unused gas should be evacuated outside of the building to avoid it being inhaled by your employees and patients. Connected to a gas evacuation ventilator, the scavenger interface controls the flow of suction and maintains the balance with the quantity of unused gas.

**IMPORTANT :** Always refer to the user manual of the option you are installing for more detailed instructions.

# OPTIONAL ACCESSORIES

## ASSEMBLY INSTRUCTIONS

**MODU**Flex

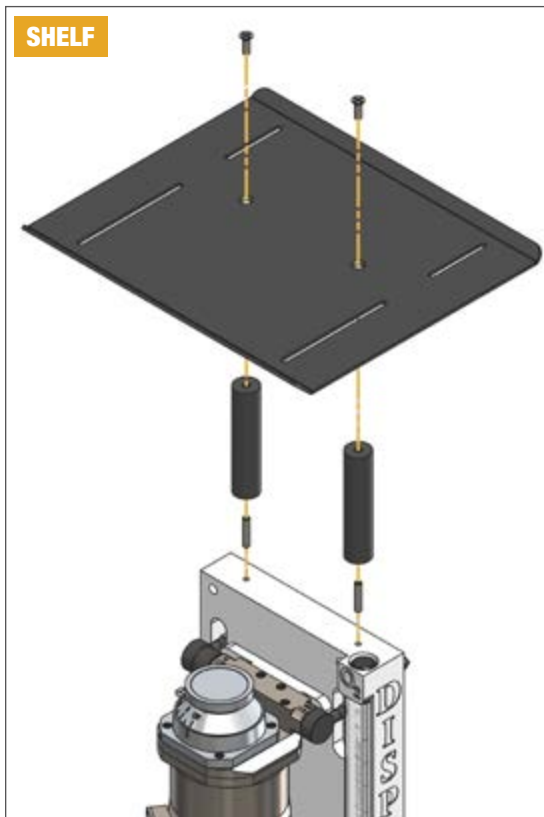

Instal the monitor shelf as illustrated.



Installation of dual cylinder holder.

The cylinder holder can be helpful in many situations. It can be very useful when there is a lack of oxygen in the central system. In the occasional case where you need to move an anesthetized animal to a room where there are no oxygen outlets, the cylinder holder enables you to keep the patient in an ideal condition.

**IMPORTANT** : Always refer to the user manual of the option you are installing for more detailed instructions.

# OPTIONAL ACCESSORIES

## ASSEMBLY INSTRUCTIONS

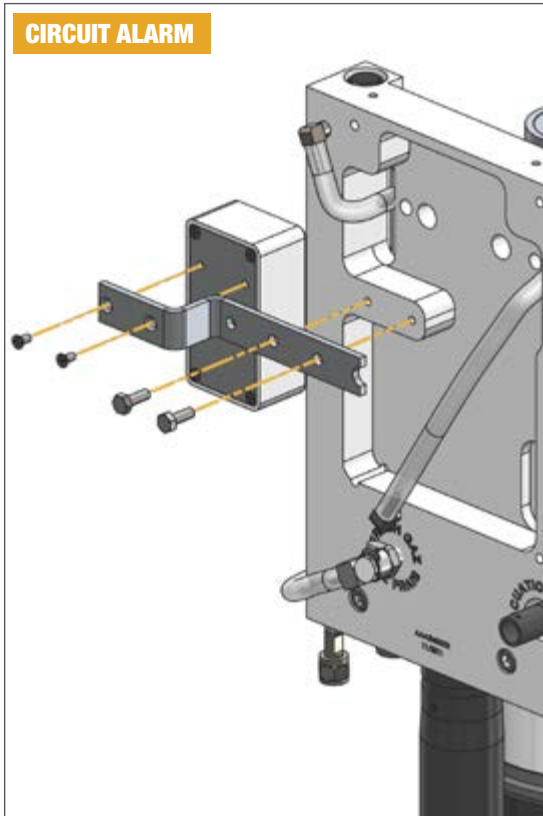

Installation of the patient circuit pressure alarm.

During assisted ventilation, the alarm will alert you if the predetermined pressure level is reached. For example, if you forget the evacuation valve in a closed position, the circuit alarm will alert you with a warning sound at the predetermined pressure.



Install wall-mount adaptor as illustrated.

**IMPORTANT** : Always refer to the user manual of the option you are installing for more detailed instructions.

# ASSEMBLED

VIEWS 2

**MODU**Flex



DISPO MED



# DAILY LEAK CHECK PROCEDURE

The unit's integrity should be verified every day, and at each replacement of patient circuit components such as breathing bags, tubes etc. A properly maintained anesthesia machine reduces gas consumption and operating room pollution.

### Prerequisites:

Oxygen supply of 40 to 60 psi (3 bar) Breathing circuit and bag.

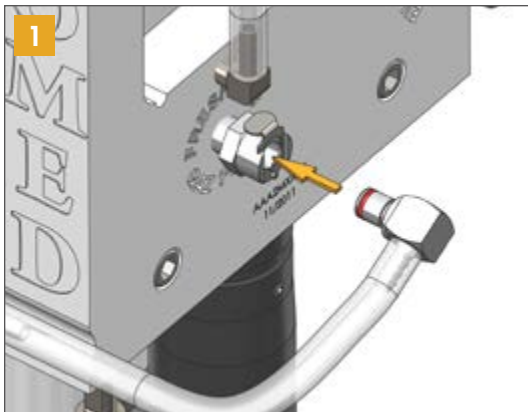

Connect the circuit to be verified to the fresh gas outlet of the anesthesia machine.

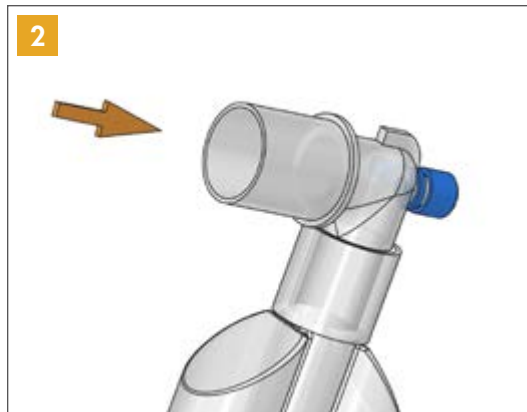

Obstruct the patient's circuit outlet with a plug or your thumb.



Open the flowmeter to approximately 200 ml.



Close the gas evacuation valve.

# DAILY LEAK CHECK PROCEDURE

**MODU**Flex

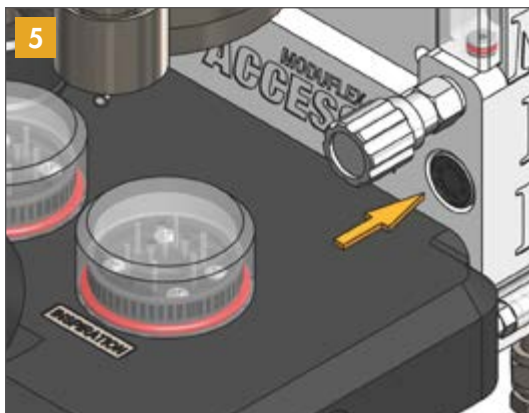

Press the oxygen flush button and hold until the pressure on the manometer indicates approximately 30 cm H<sub>2</sub>O.



Check the manometer. The pressure must not drop (But it can increase). If the pressure drops, replace the patient circuit and the bag and try again.



**Caution:** Open the evacuation valve before using the anesthesia machine again.

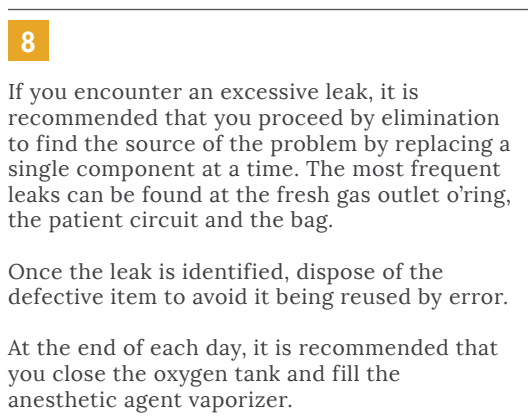

If you encounter an excessive leak, it is recommended that you proceed by elimination to find the source of the problem by replacing a single component at a time. The most frequent leaks can be found at the fresh gas outlet o'ring, the patient circuit and the bag.

Once the leak is identified, dispose of the defective item to avoid it being reused by error.

At the end of each day, it is recommended that you close the oxygen tank and fill the anesthetic agent vaporizer.

  
DISPOMED

# ANNUAL MAINTENANCE



## Prerequisite:

Preventative maintenance  
kit # 975-0900-900

The maintenance kit contains all the necessary parts to perform the annual maintenance. Refer to this technical drawing the parts to be replaced are identified. It is important to perform the daily leak check procedure (page 17) once the maintenance has been completed.

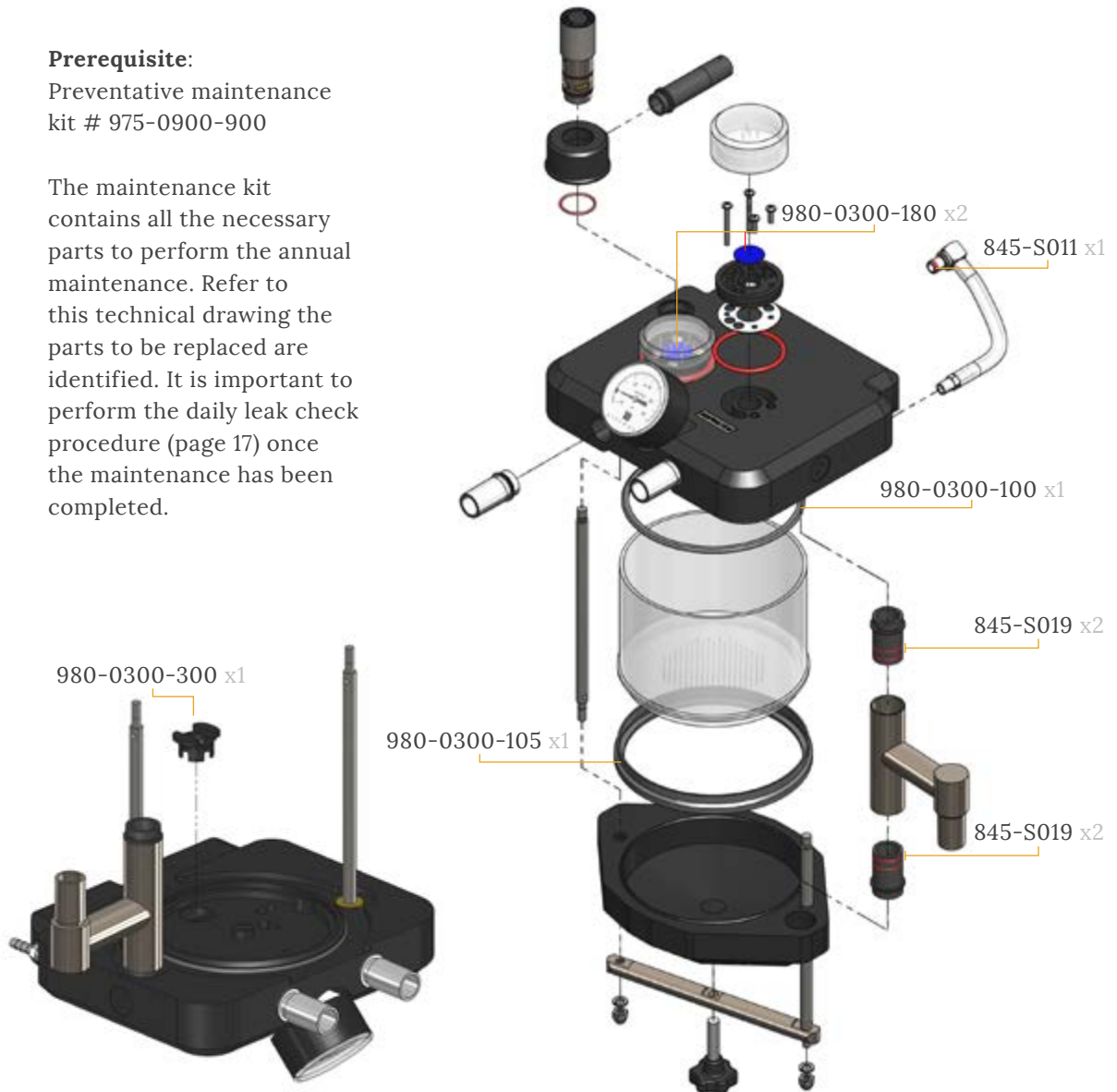

DISPOME

# CONSUMABLES MATERIALS LIST

## REBREATHING BAGS



**0.5 liter:** # 940-321525

**1 liter:** # 940-321625

**2 liters:** # 940-321725

**3 liters:** # 940-321825

## Y PATIENT CIRCUIT



# 940-3704-800

## CARBON DIOXIDE ABSORBENT



**1.6 liters:** # 905-8855-000

**18.9 liters:** # 905-8862-000

## KRYTOX



**7g:** # 850-0052-000

## GAS EVACUATION TUBING



**5':** # 985-0060-000

Dispomed Ltd. guarantees that the Access 2 anesthesia machine is free from manufacturing defects for a period of five (5) years from the date of delivery to the customer, provided that it is used according to the instructions provided and that the prescribed maintenance and service are performed.

Dispomed shall not be held liable for damage, injury or loss arising out of the use of the product, whether as a result of a defect in the product or otherwise, if, prior to such damage, injury or loss, the product was:

1. Damaged, misused or misapplied;
2. Repaired, altered or modified by a person other than a Dispomed Ltd. technician or approved service person;
3. Not installed in strict compliance with the instructions provided by Dispomed or with the applicable codes and ordinances in place;
4. Cleaned using alcohol or other damaging products.

Plastic, rubber and consumable items are guaranteed to be free of defects at the date of delivery to the customer.

Any product which proves to be defective in workmanship or material will, at Dispomed's discretion, either be repaired or replaced. Dispomed Ltd. is not responsible for deterioration, wear or abuse of this unit. This warranty shall be void for any product on which the serial number has been altered, defaced or removed.

Shipping charges for any unit repaired or replaced are the responsibility of the customer. Loaner units are available while your unit is being repaired.

## **SERVICE AND INFORMATION CENTER**

Contact us at:

T: 1-800-363-1746

T: 450-759-9395

F: 450-759-8181

Email: [info@dispomed.com](mailto:info@dispomed.com)

Website: [www.dispomed.com](http://www.dispomed.com)

Skype: [dispomed.line](https://www.skype.com/people/dispomed.line)

Facebook: [www.facebook.com/dispomed](https://www.facebook.com/dispomed)

Twitter: [twitter.com/Dispomed](https://twitter.com/Dispomed)

Info-blog: [www.veterinary-equipment.net](http://www.veterinary-equipment.net)

# ORDER PART NUMBERS

**MODU**Flex



  
DISPOMED

# REORDER PART NUMBERS

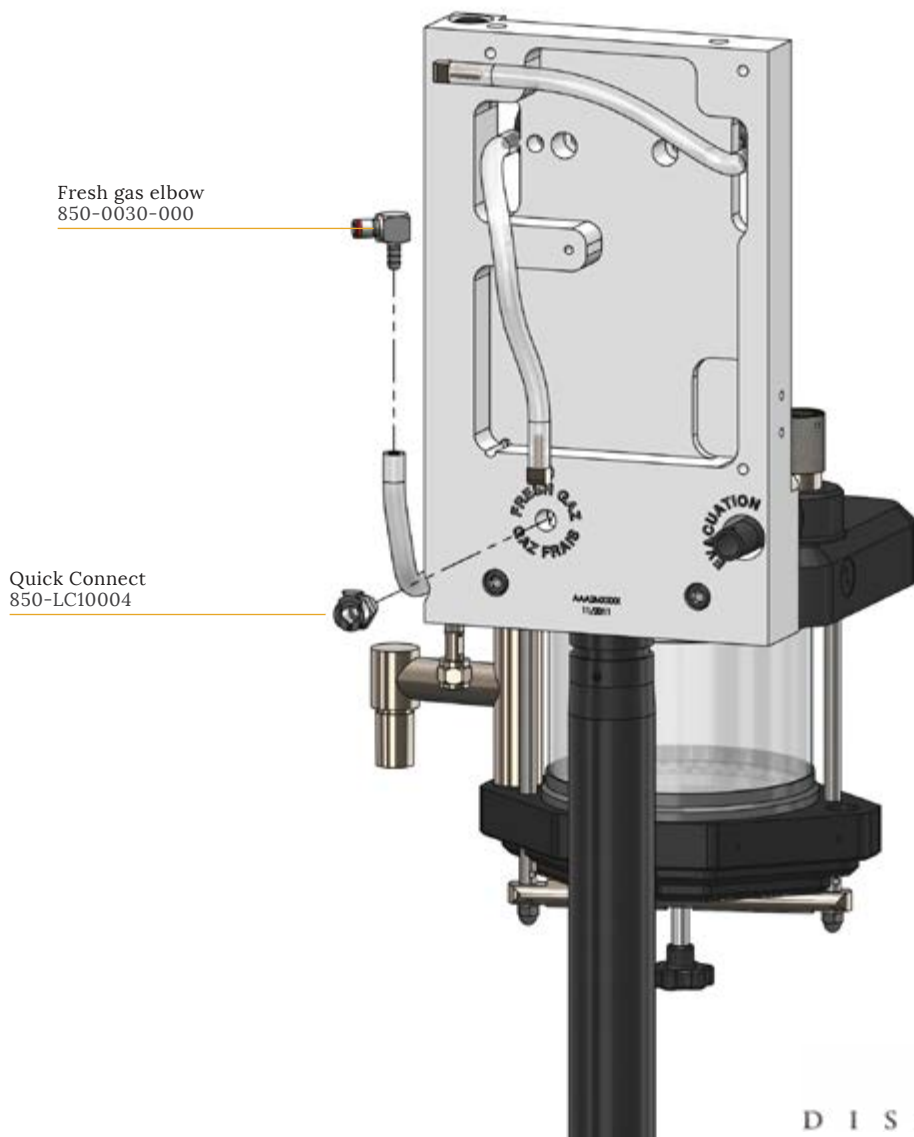

*MODUFLEX*  
**ACCESS2**  
*by DISPOMED*

---

**Manufactured by Dispomed Ltd**

745 Nazaire-Laurin Joliette (QC) Canada J6E 0L6  
Phone : 1-800-363-1746 (Canada and U.S.A only)  
Phone : 1-450-759-9395  
fax : 1-450-759-8181

info@dispomed.com  
[www.dispomed.com](http://www.dispomed.com)



D I S P O M E D

PRINTED IN CANADA